

**Before replacing/adding the battery**

- 1) These instructions should be carefully followed during replacing the battery.
- 2) These instructions should be passed on by the installer to the user.
- 3) The product should not be modified in any way except in accordance with those modifications described in these instructions.

**Replacing/adding the battery in iLOQ D10S.x Europrofile cylinder**

**1**

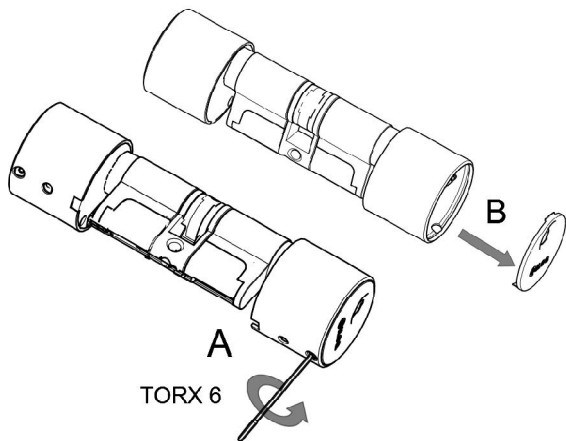

- A. Insert a TORX 6 tool into the knob hole and remove the screw.
- B. Remove the front plate.

**2**

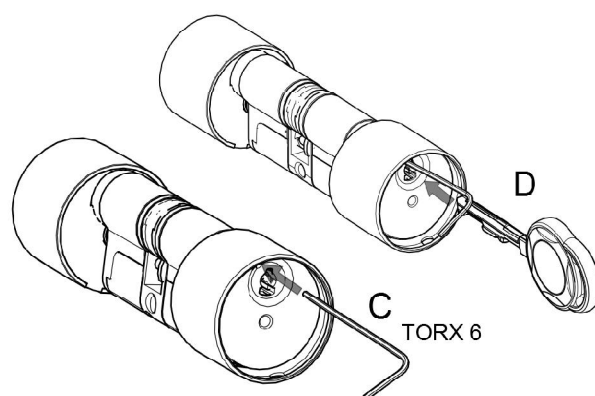

- C. Insert the TORX tool 6 into the marked hole.
- D. Insert an authorized key into the cylinder.

**3**

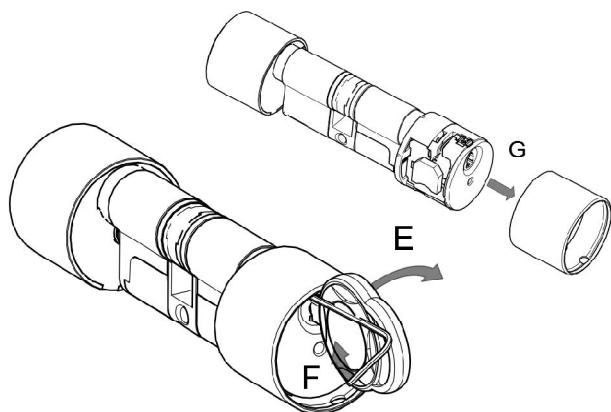

- E. Turn the authorized key 15° clockwise.
- F. Turn the TORX 6 tool ~90° clockwise.
- G. Remove the knob cover.

**4**

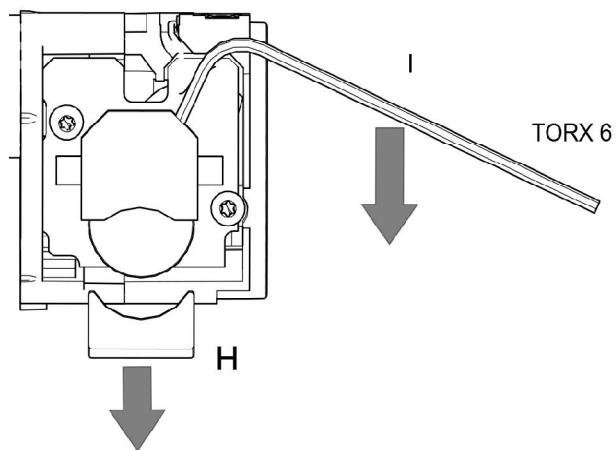

- H. Remove the battery cover from the battery holder.
- I. Slide old battery out from the battery holder with the TORX 6 tool.

Replace the battery with a new one. Put the battery cover back in its place.

**5**

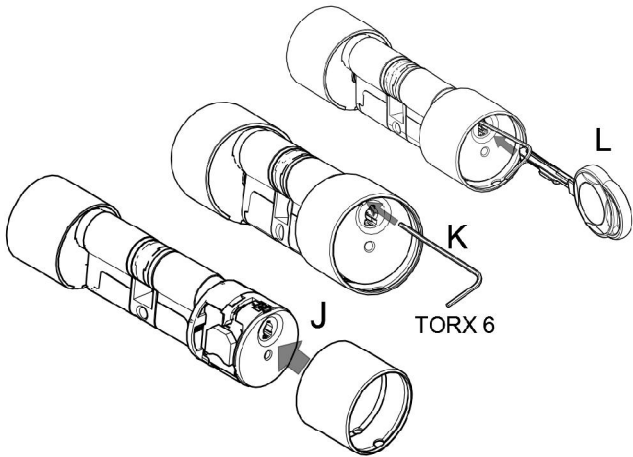

- J. Slide the knob cover fully in its place.
- K. Insert the TORX 6 tool into the cover hole.
- L. Insert authorized key into the cylinder.

**6**

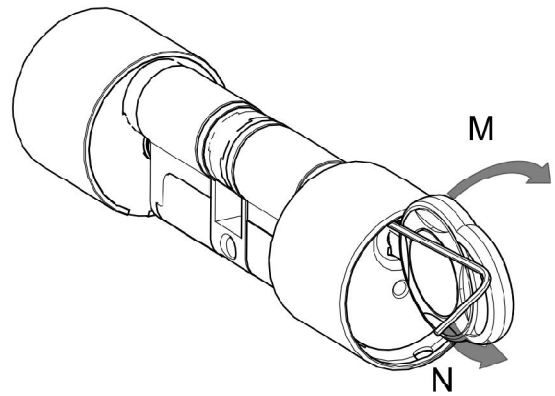

- M. Turn authorized key ~15°.
- N. Turn the TORX 6 tool 90° counterclockwise.

**7**

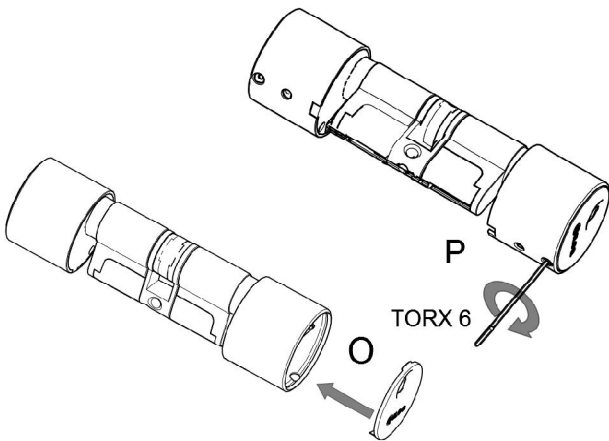

- O. Install the front plate.
- P. Tighten the screw. Use tightening torque 0.35 ...0.45 Nm.

**8**

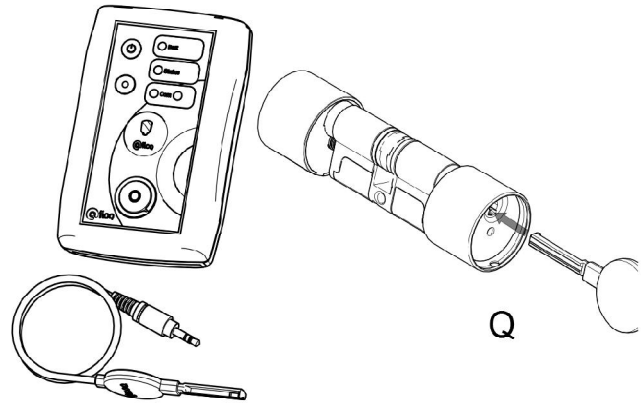

- Q. After **adding** a Clock battery, the cylinder must be reprogrammed.

The Clock starts running after getting the time information from the Programming device while programming the cylinder. The Cylinder also reports having an RTC to the S10 software.

After **replacing** a Clock battery, reading its audit trails starts the clock. Reprogramming is not needed.