



**H50S.x31.HC**  
**H50S.x41.HC**

**PADLOCK**  
**MOUNTING- AND CARE INSTRUCTIONS**

## TABLE OF CONTENTS

<b>1. BEFORE INSTALLATION .....</b>	<b>3</b>
<b>2. AFTER INSTALLATION .....</b>	<b>3</b>
<b>3. CARE.....</b>	<b>3</b>
<b>4. INSTALLATION OF ILOQ H50S .....</b>	<b>4</b>
<b>5. OPERATING INSTRUCTIONS OF iLOQ H50S.....</b>	<b>4</b>
<b>5.1. OPENING.....</b>	<b>4</b>
<b>5.2. CLOSING.....</b>	<b>7</b>
<b>5.2.1. Locking manually (H50S.x41 versions) .....</b>	<b>7</b>
<b>5.2.2. Locking with key (H50S.x31 versions) .....</b>	<b>8</b>
<b>6. REPLACING THE READER KNOB .....</b>	<b>10</b>
<b>7. GENERAL NOTES .....</b>	<b>11</b>
<b>8. DECLARATION OF CONFORMITY .....</b>	<b>11</b>

## 1. BEFORE INSTALLATION

1. The instructions should be carefully followed during installation. These instructions and any maintenance instructions should be passed on by the installer to the user.
2. iLOQ H50S padlock must be installed and used carefully without excessive force.
3. Do not drop the product.
4. The product should not be modified in any way except in accordance with the modifications described in these instructions.
5. Care should be taken to ensure that any seals or weather-stripping fitted to the complete door assembly, does not inhibit the correct operations of the key tube cylinder.
6. Care should be taken to ensure that no projection of the D50S cylinder and associated parts, can prevent the door swinging freely.
7. No liability is accepted for damage to the doors or components due to incorrect installation.
8. We reserve the right to make modifications or further technical developments without further notice.
9. If there are any deviations from the contents in foreign language versions of the documentation, the English original shall apply in case of doubt.

## 2. AFTER INSTALLATION

Test the padlock functionality after installation to ensure that it does not prevent the lock application from working properly.

## 3. CARE

The product is designed to be maintenance-free. It does not require any regular maintenance.

## 4. INSTALLATION OF ILOQ H50S

Not applicable, for operating instructions see chapter 5.

---

## 5. OPERATING INSTRUCTIONS OF ILOQ H50S

Please note: Due to the large variety of Android phone models and operating system versions, iLOQ cannot guarantee that all NFC-enabled Android phones will work seamlessly with our locks.

Before using the locks, please check the location of the NFC antenna in your phone so that you know the best position to hold the phone against the lock-reader knob.

### 5.1. OPENING

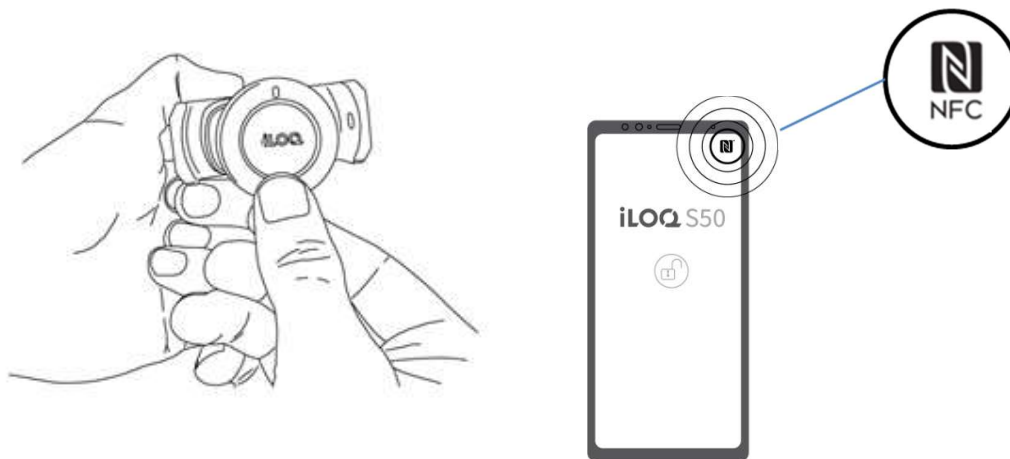

#### Key Fob (left picture):

Place the Key Fob (with valid access rights) in the middle of the black knob, as shown on the picture above and below, and wait until the key shows a green light.

#### Mobile phone (right picture):

Place the NFC aerial in the middle of the knob, as shown on the picture below. The NFC aerial inside the Mobile phones can be placed in different areas, please check the datasheets from the mobile phone manufacturer.

1. Present a valid key to the reader knob and wait until the key shows a green light to indicate that the lock is open. Valid key could be Android mobile device with iLOQ app and NFC capability or iLOQ key Fob.



2. Turn the reader knob clockwise 180°.



3. Pull the shackle open.

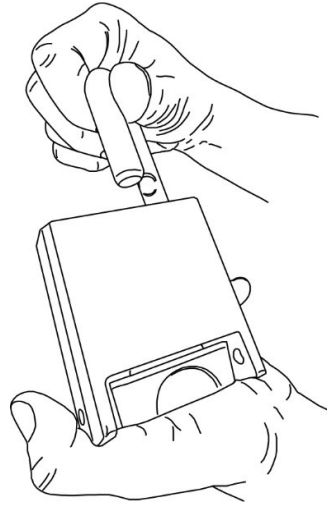

## 5.2. CLOSING

### 5.2.1. Locking manually (H50S.x41 versions)

1. Close the shackle

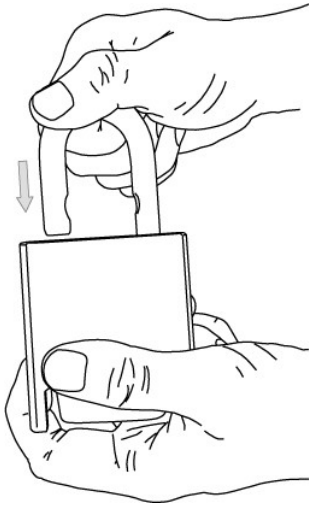

2. Turn the reader knob 180° counterclockwise. After turning the knob, it takes from 5 to 15 seconds before lock is in locked.

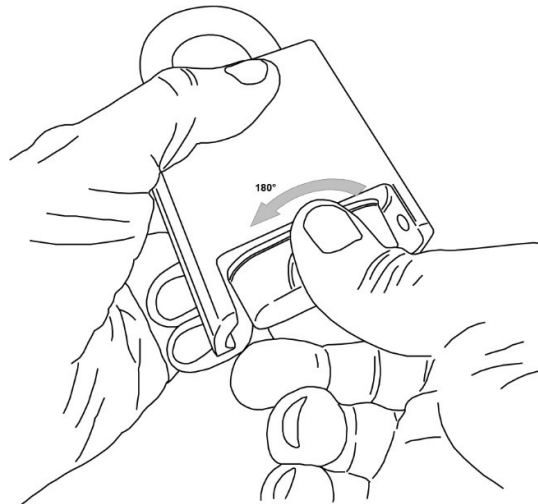

3. After 5 to 15 seconds ensure the knob is in locked position and door remains closed.

### 5.2.2. Locking with key (H50S.x31 versions)

1. Close the shackle.



2. Present a valid key to the reader knob and wait until the key shows a green light to indicate that the lock is open. Valid key could be mobile device with iLOQ app and NFC capability or iLOQ Key Fob.

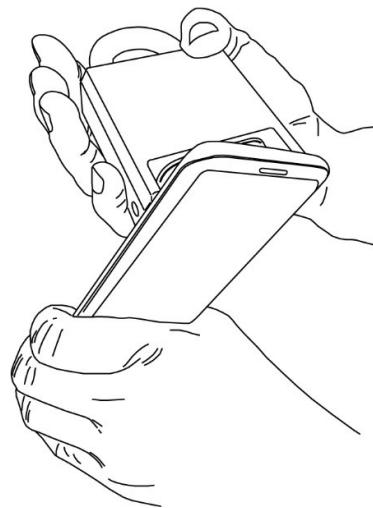



3. Turn the reader knob 180° counterclockwise.  
After turning the knob, it takes from 5 to 15 seconds before lock is in locked position (depending on the configured lock opening time).

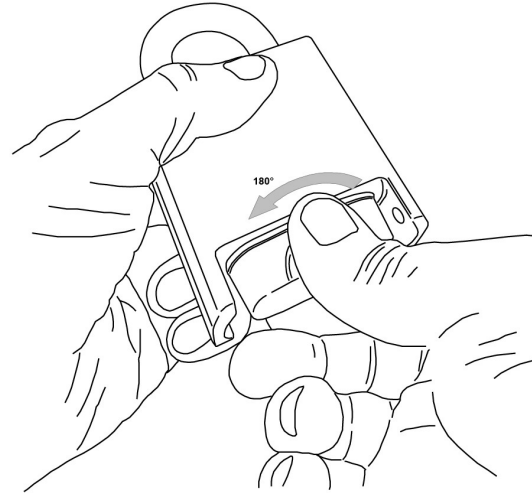
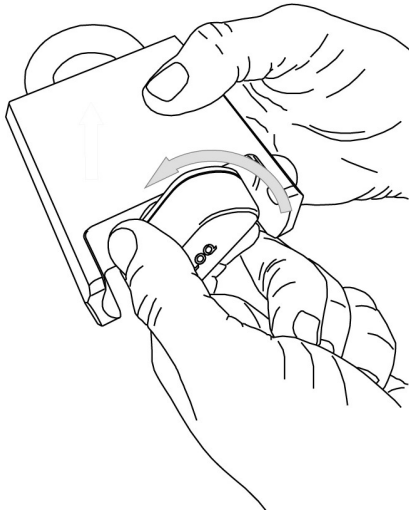

4. After 5 to 15 seconds ensure the knob is in locked position and door remain closed.

## 6. REPLACING THE READER KNOB

If the reader knob is e.g. damaged and needs replacement knob, please follow instructions how to replace the reader knob correctly.

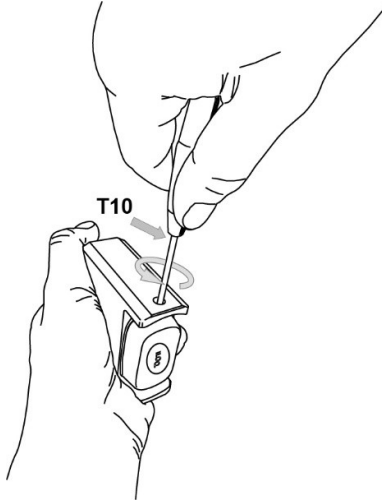

1. Loosen the fixing screw



2. Pull the knob off

3. Before installing the new knob, add slight amount of CRC silicon grease to the knobs IP gasket.

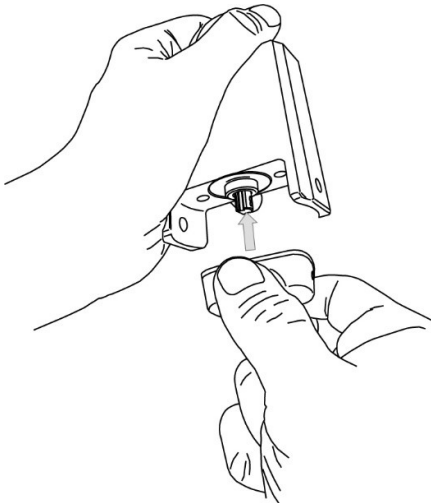

Insert the new knob on

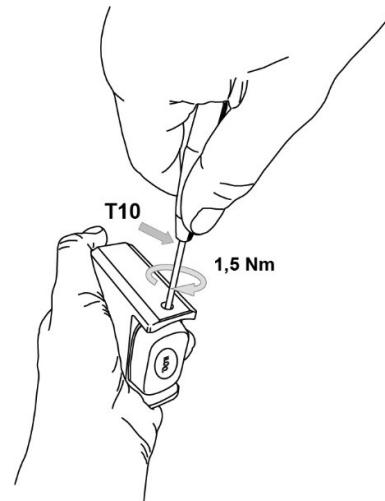

5. Tighten the fixing screw

## 7. GENERAL NOTES

1. Care should be taken to ensure that any seals or weather-stripping fitted to the complete door assembly, does not inhibit the correct operations of the cylinder.
2. Care should be taken to ensure that no projection of the cylinder and associated parts, can prevent the door swinging freely.
3. All components necessary for the specific installation should be fitted.
4. The key is to be kept securely so that only authorized person may have access.
5. In case of losing a key, blocklisting of the lost key shall be done with the iLOQ Manager software and affected locks shall be reprogrammed.

## 8. DECLARATION OF CONFORMITY

The products mentioned inside this user guide are in conformity with the requirements of the following directives:

- 2014/53/EU Radio Equipment Directive (RED)
- 2011/65/EU Restriction of the use of certain hazardous substances (RoHS)

The conformity was assessed in accordance with RED module A by using the following harmonized and other EN standards:

RED:

Art 3.1(a) Safety	EN 62368-1:2014 (2nd Ed) EN 60065:2014 (8th Ed) EN 60950-1:2005 (2nd Ed) + A1:2019 + A2:2013
Art 3.1(b) EMC EN	EN 301 489-1 v2.2.3 EN 301 489-3 v2.1.1
Art 3.2 Spectrum RoHS	EN 300 330 v2.1.1 EN 50581:2012

Other standards used:  
EN 15684:2020