



**G50S.2x1  
CAM LOCK CYLINDER  
INSTALLATION, OPERATING AND  
CARE INSTRUCTIONS**

---

## **TABLE OF CONTENTS**

|           |  |           |
|-----------|--|-----------|
| <b>1.</b> | <b>BEFORE INSTALLATION.....</b>                        | <b>3</b>  |
| <b>2.</b> | <b>CARE &amp; MAINTENANCE.....</b>                     | <b>3</b>  |
| <b>3.</b> | <b>INSTALLATION OF ILOQ G50S.2X1.....</b>              | <b>4</b>  |
| <b>4.</b> | <b>OPERATING INSTRUCTIONS OF ILOQ G50S.2X1 .....</b>   | <b>5</b>  |
| 4.1       | Opening .....  | 5         |
| 4.2       | Locking .....  | 6         |
| 4.2.1     | Locking manually .....                                 | 6         |
| 4.2.2     | Locking with key.....                                  | 7         |
| <b>5.</b> | <b>REPLACING THE READER KNOB .....</b>                 | <b>8</b>  |
| <b>6.</b> | <b>REPLACING THE READER KNOB WITH ESCUTCHEON .....</b> | <b>9</b>  |
| <b>7.</b> | <b>OTHER INFORMATION .....</b>                         | <b>10</b> |
| <b>8.</b> | <b>DECLARATION OF CONFORMITY .....</b>                 | <b>10</b> |

---

## **1. BEFORE INSTALLATION**

- 1) These instructions should be carefully followed during installation.
- 2) These instructions should be passed on by the installer to the user.
- 3) iLOQ G50S cylinders must be installed and used effortlessly without the use of excessive force.
- 4) The product should not be modified in any way except in accordance with those modifications described in these instructions.

## **2. CARE & MAINTENANCE**

The product is designed to be maintenance-free. It doesn't require any regular maintenance.

---

### 3. INSTALLATION OF ILOQ G50S.2X1

These instructions should be carefully followed during installation.

Use appropriate escutcheon and/or adapter type according to the installation environment: G50S for Finnish installations – no need for adapters. G50S for other market areas – adapter kit AG50.5 may be needed due the pre-drilled assembly hole on the door.

Installation example:

G50S.2x1

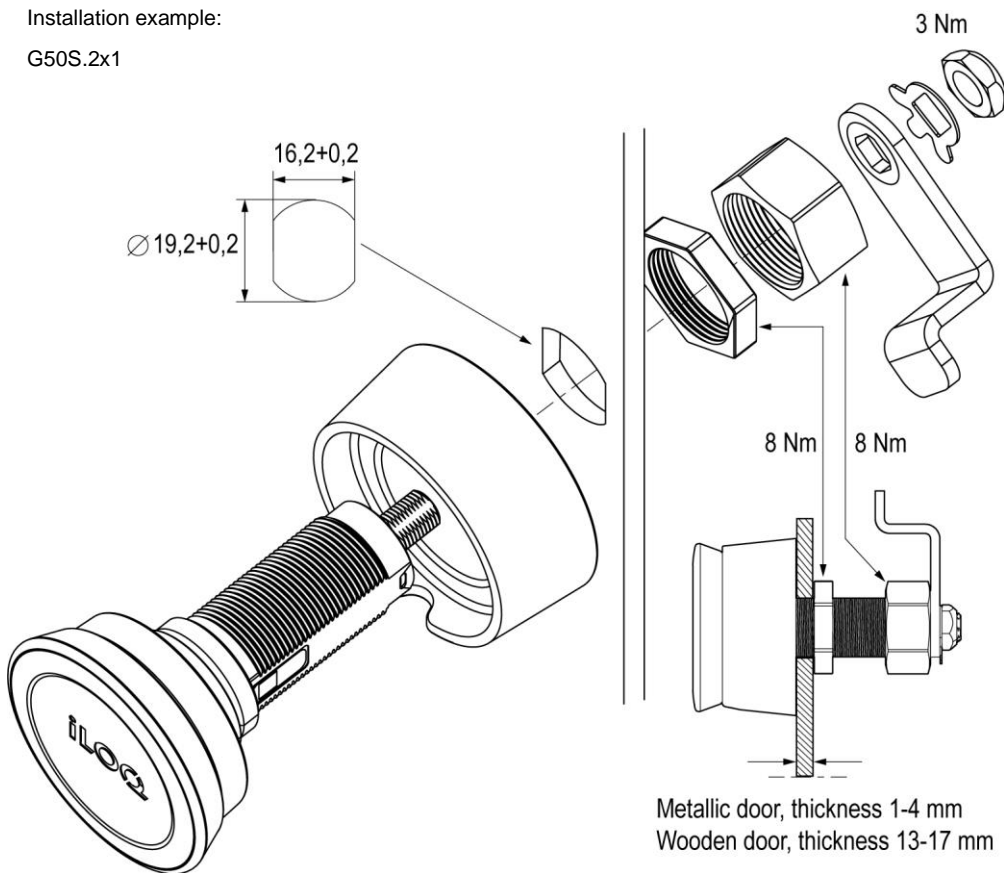

Use reasonable force (approx. 8 Nm) when tightening the cylinder fixing nut.

Use reasonable force (approx. 8 Nm) when tightening the security nut.

Use reasonable force (approx. 3 Nm) when tightening the latch fixing.

Use the locking washer to secure the latch fixing nut once tightened.

Pay attention to the dimensions of the latch so that the latch is not under pressure when opening or closing the lock. If the latch is under pressure, it may prevent lock functioning properly and may cause damage to the lock.

## 4. OPERATING INSTRUCTIONS OF ILOQ G50S.2X1

### 4.1 Opening

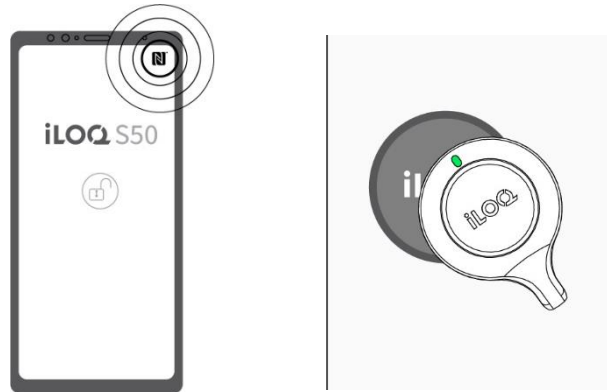

1. Present a valid key to the reader knob and wait until the key shows a green light to indicate that the lock is open. Valid key could be Android mobile device with iLOQ app and NFC capability or iLOQ key Fob.

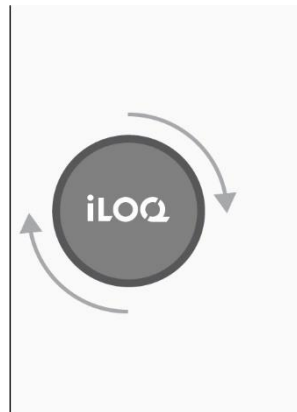

2. Turn the reader knob clockwise

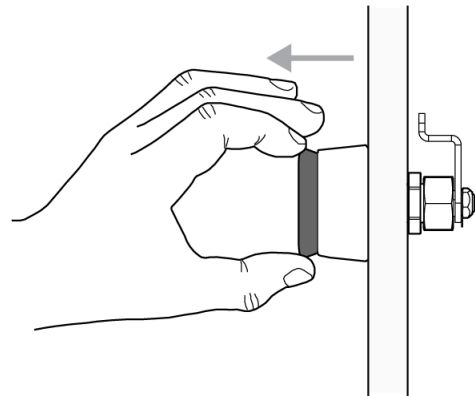

3. Pull the door open.

## 4.2 Locking

### 4.2.1 Locking manually

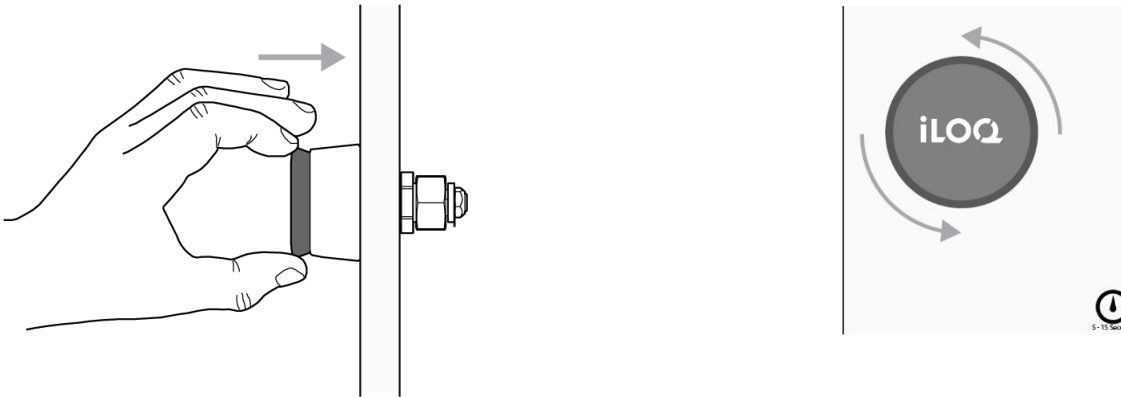

1. Push the door to closed position and turn the reader knob counterclockwise. After turning the knob, it takes from 5 to 15 seconds before lock is in locked position.

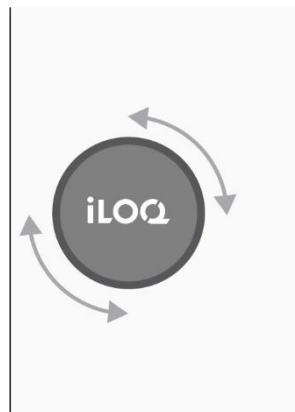

2. After 5 to 15 seconds ensure the knob is in locked position and door remains closed.
-

#### 4.2.2 Locking with key

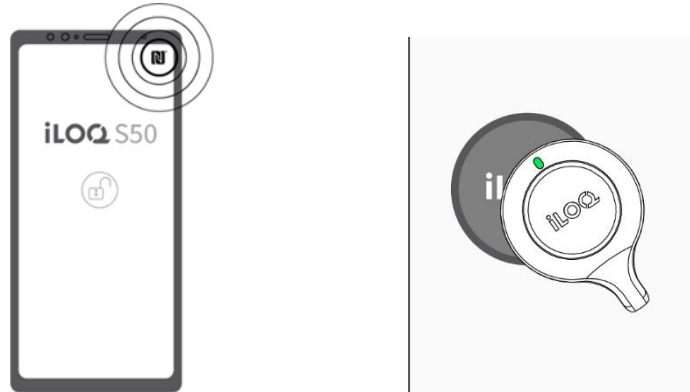

1. Present a valid key to the reader knob and wait until the key shows a green light to indicate that the lock is open. Valid key could be Android mobile device with iLOQ app and NFC capability or iLOQ key Fob.

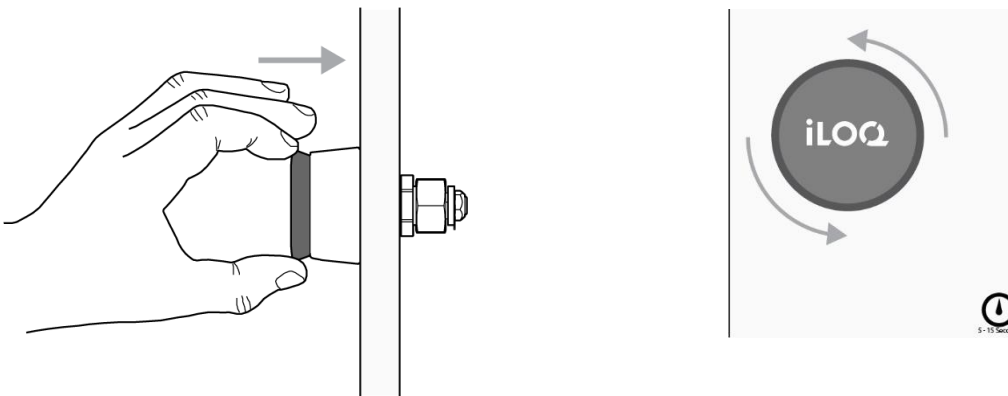

2. Push the door to closed position and turn the reader knob counterclockwise. After turning the knob, it takes from 5 to 15 seconds before lock is in locked position.

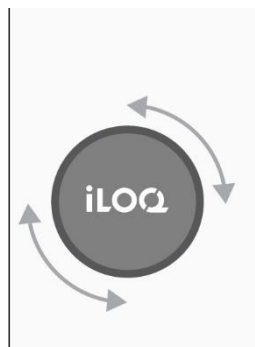

3. After 5 to 15 seconds ensure the knob is in locked position and door remain closed.

## 5. REPLACING THE READER KNOB

If the reader knob is damaged and needs replacement knob, please follow instructions how to replace the reader knob correctly.

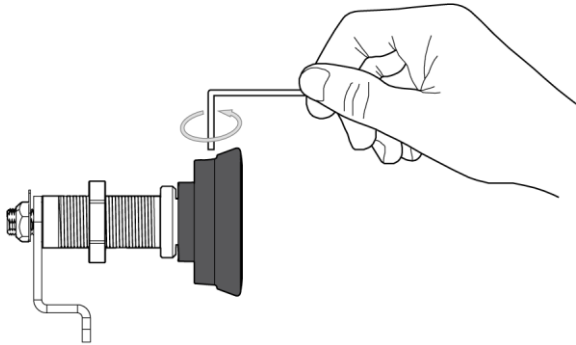

1. Loosen the fixing screw

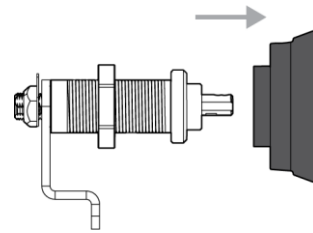

2. Pull the knob off

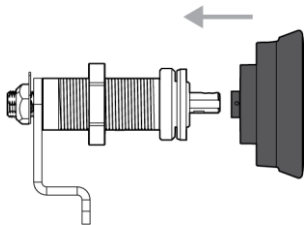

3. Insert the knob on

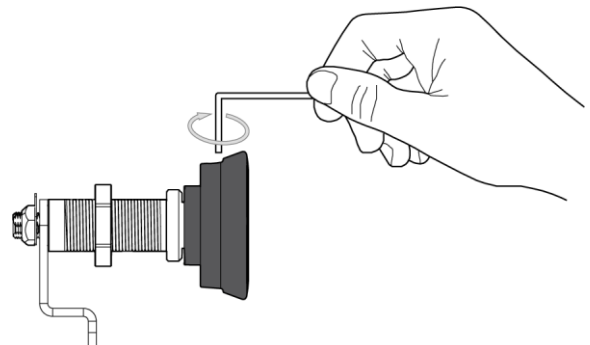

4. Tighten the fixing screw

---



## 6. REPLACING THE READER KNOB WITH ESCUTCHEON

If the reader knob is damaged and needs replacement knob, please follow instructions how to replace the reader knob correctly.

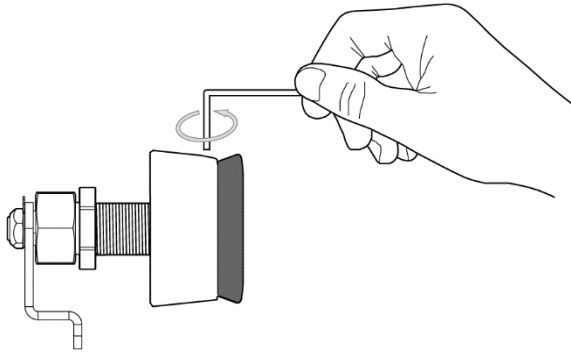

1. Loosen the fixing screw

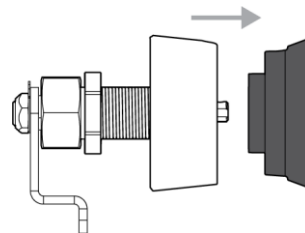

2. Pull the knob off

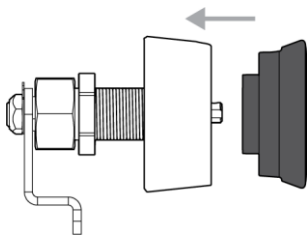

2. Insert the knob on

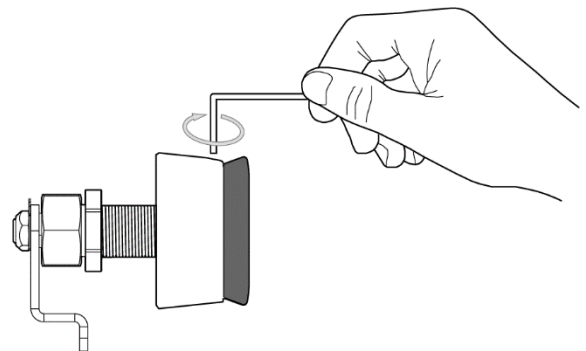

4. Tighten the fixing screw

---

## 7. OTHER INFORMATION

Care should be taken to ensure that any seals or weather-stripping fitted to the complete door assembly, does not inhibit the correct operations of the cylinder.

Before fitting the cylinder to a fire/smoke resisting door, the fire certification should be examined, to ensure conformity.

Care should be taken to ensure that no projection of the cylinder and associated parts, can prevent the door swinging freely.

These instructions and any maintenance instructions should be passed on by the installer to the user.

The lock cylinder has 24 months warranty.

iLOQ cylinders are recyclable as metal scrap. So are also iLOQ cylinder rings, accessories and tail piece sets.

## 8. DECLARATION OF CONFORMITY

The products mentioned inside this user guide are in conformity with the requirements of the following directives:

- 2014/53/EU Radio Equipment Directive (RED)
- 2011/65/EU Restriction of the use of certain hazardous substances (RoHS)
- 

The conformity was assessed in accordance with RED module A by using the following harmonized and other EN standards:

RED:

|                   |  |
|-------------------|--|
| Art 3.1(a) Safety | EN 62368-1:2014 (2nd Ed)<br>EN 60065:2014 (8th Ed)<br>EN 60950-1:2005 (2nd Ed) + A1:2019 + A2:2013 |
| Art 3.1(b) EMC EN | EN 301 489-1 v2.2.3<br>EN 301 489-3 v2.1.1   |
| Art 3.2 Spectrum  | EN 300 330 v2.1.1  |
| RoHS              | EN 50581:2012  |

Other standards used:

EN 15684:2020

---